

REFUGEES' HOUSING SOLUTION WITHIN THE HOST COMMUNITY IN THE EAST CENKARENG

REZA REZAIE

The aim of this research is to elaborate a connection on Maslow's basic need theory of a human beings and Vitruvius theory on the three basic elements of good architectural design that were strength, functionality, and beauty and meet the WHO Housing and Health Guide which will create the Housing Solution for refugees that will grow together with the host community in the East Cengkareng.

During uncertainty about the relevant legal instruments, social interaction between the refugees and their host communities cannot be avoided (Zulfa, 2018).

Why East Cengkareng?

East Cengkareng is an area of Tzu Chi Foundation Flat Housing Complex, which now is one of UNHCR's active partner (UNHCR Indonesia, 2021). There are now 2 Afghan refugees who are studying in Tzu Chi East Cengkareng Senior High School and live in Tzu Chi Flat Housing Complex (Haidari, 2021)



IDENTIFY 3 KEY CONCEPT

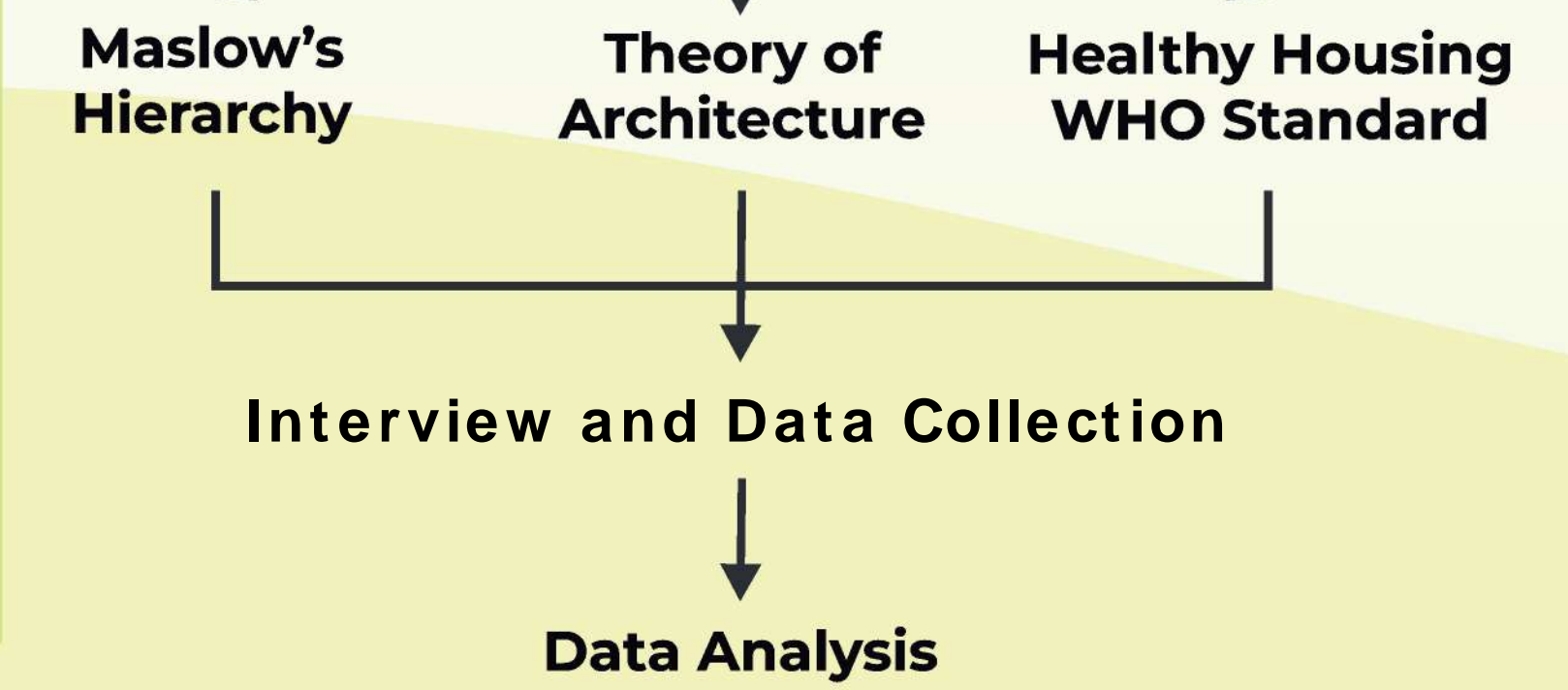

Both sides of the building are used for the road access. There's a parking area in the Ground Floor



The dry market is used in the morning. The stairs can also be used as a place to watch the soccer matches



On the 3rd floor, there's an outdoor space which is used for children play area and sport area. On the outskirts, there is a 1.5 meter high wall for the safety and security of residents

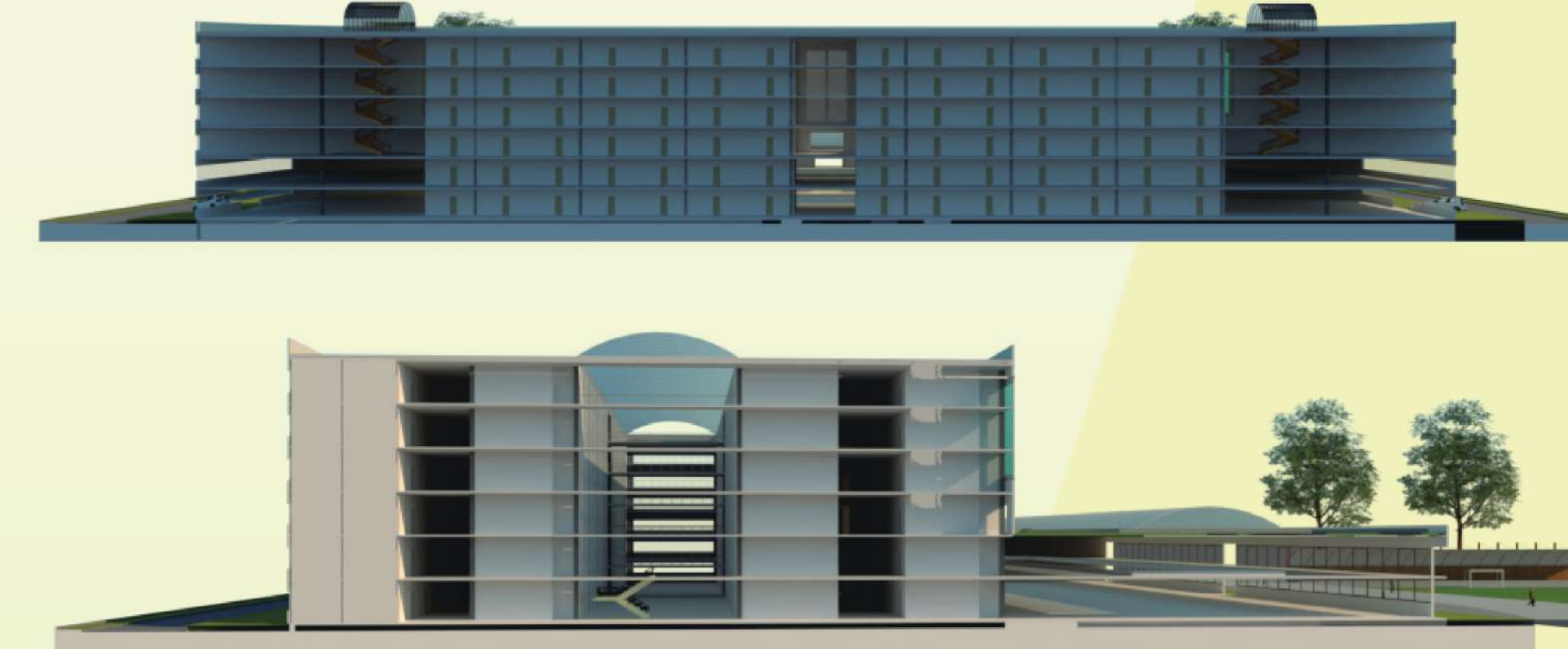

On top of the building is the area for urban farming and the placement of solar panels for energysaving and renewable. The skylight is made of patterned laminated glass so that the light can enter but the heat is blocked



The public facilities are market, park, and soccer field

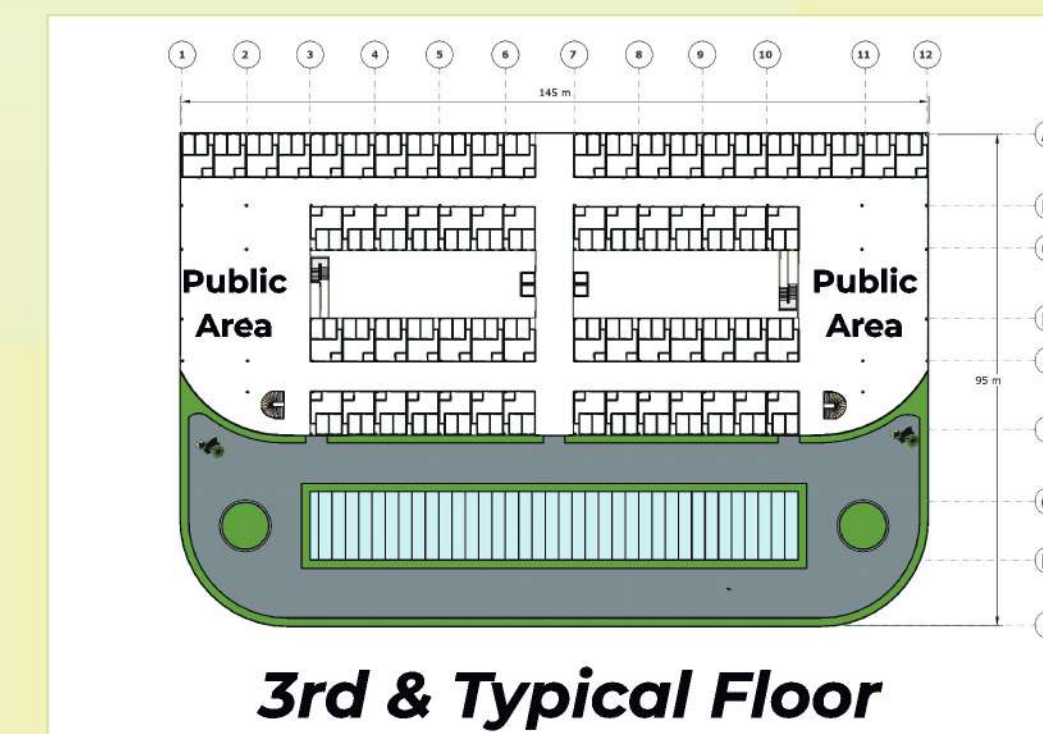

3rd & Typical Floor

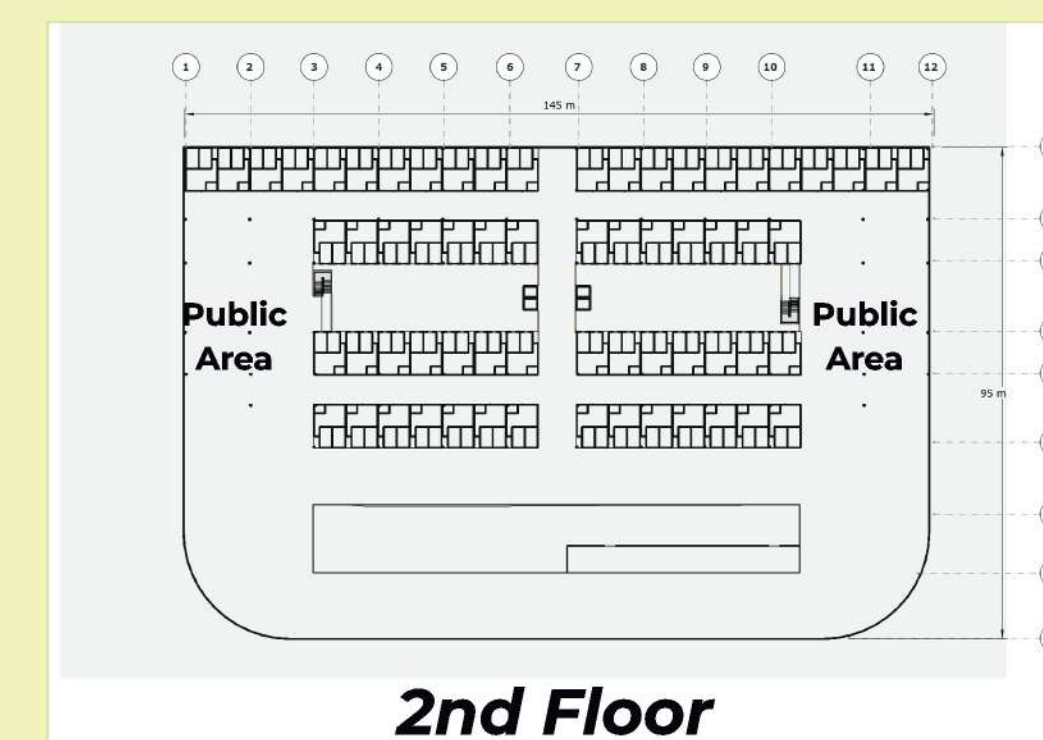

2nd Floor

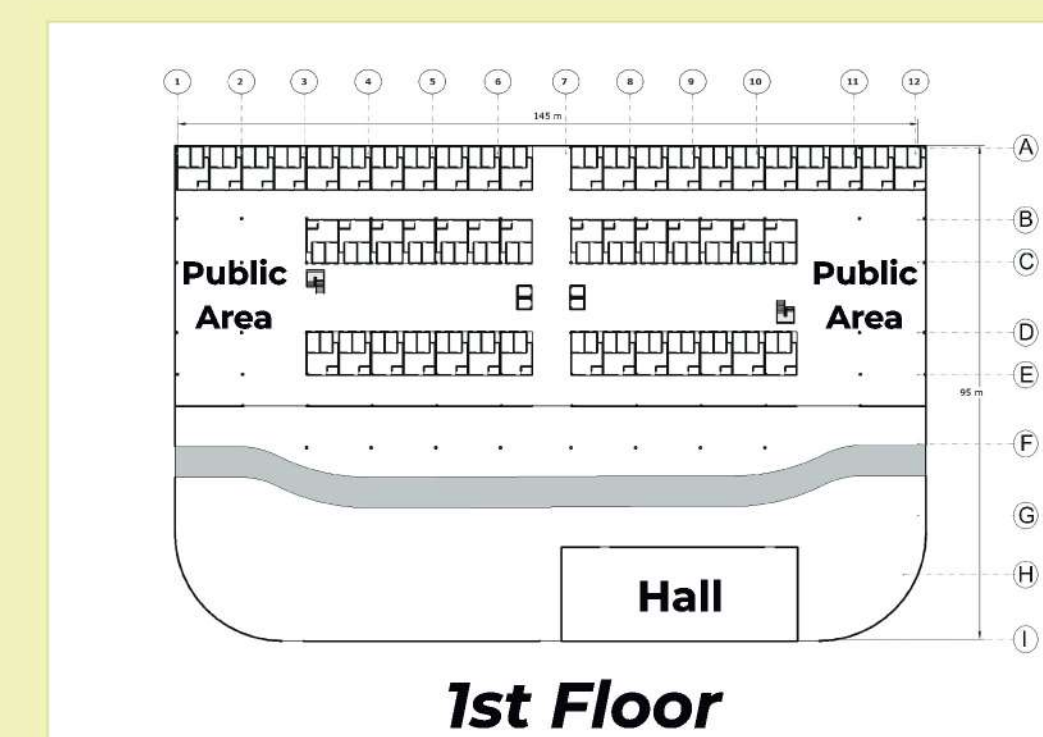

1st Floor

The circulation is using wire mesh in both of the sides. This will bring the wind in and push the hot temperature out through the tall central holes with another function, which is the skylight.

Other reason for using wire mesh is to create a place to contemplate with clear mind and to prevent the refugees kill them selves by throwing their body out of the window.

The hall before the wire mesh wall, is used as general area for the refugees to gather for a simple thing to such as sewing in groups, small talks, or children's play area.

From the hall's side, there's an area for skylight and we can see the whole internal building. Every side of the room get good lighting.

All of the wall material is using concrete with noise reduction so the sound from the out side of the building is not going to disturb the residents.

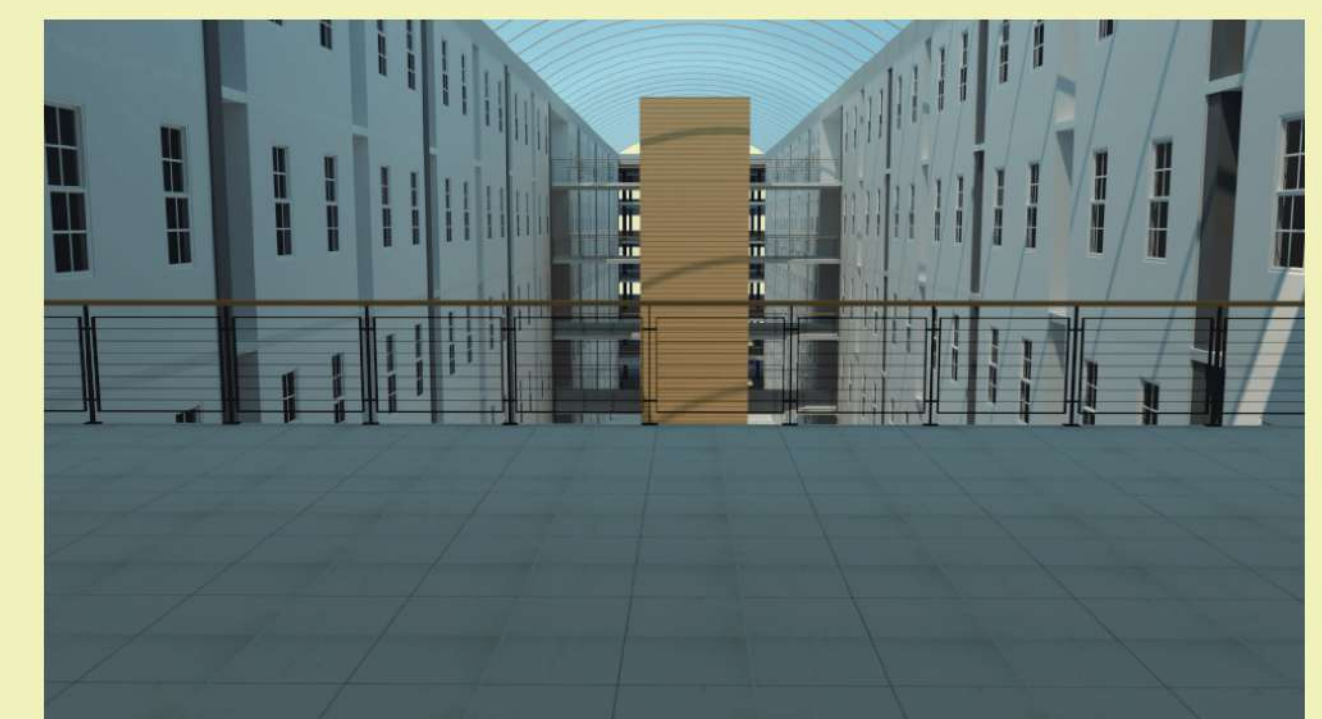
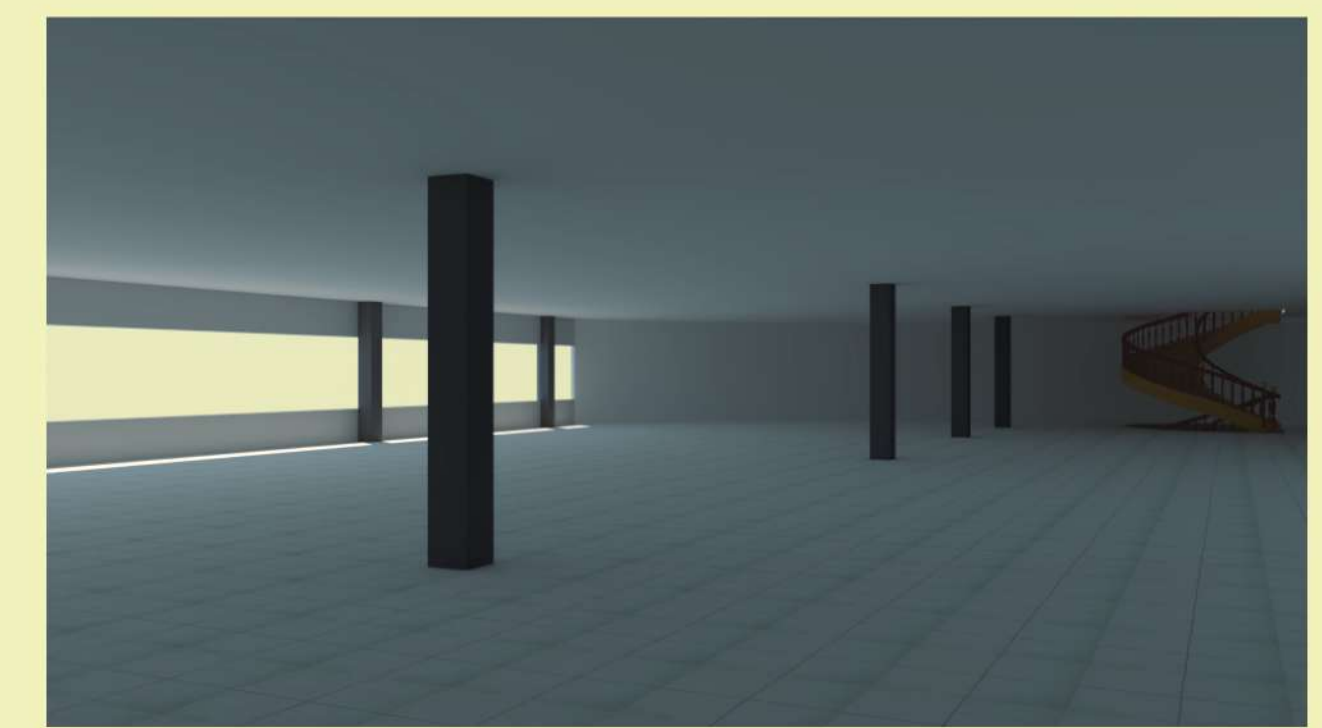
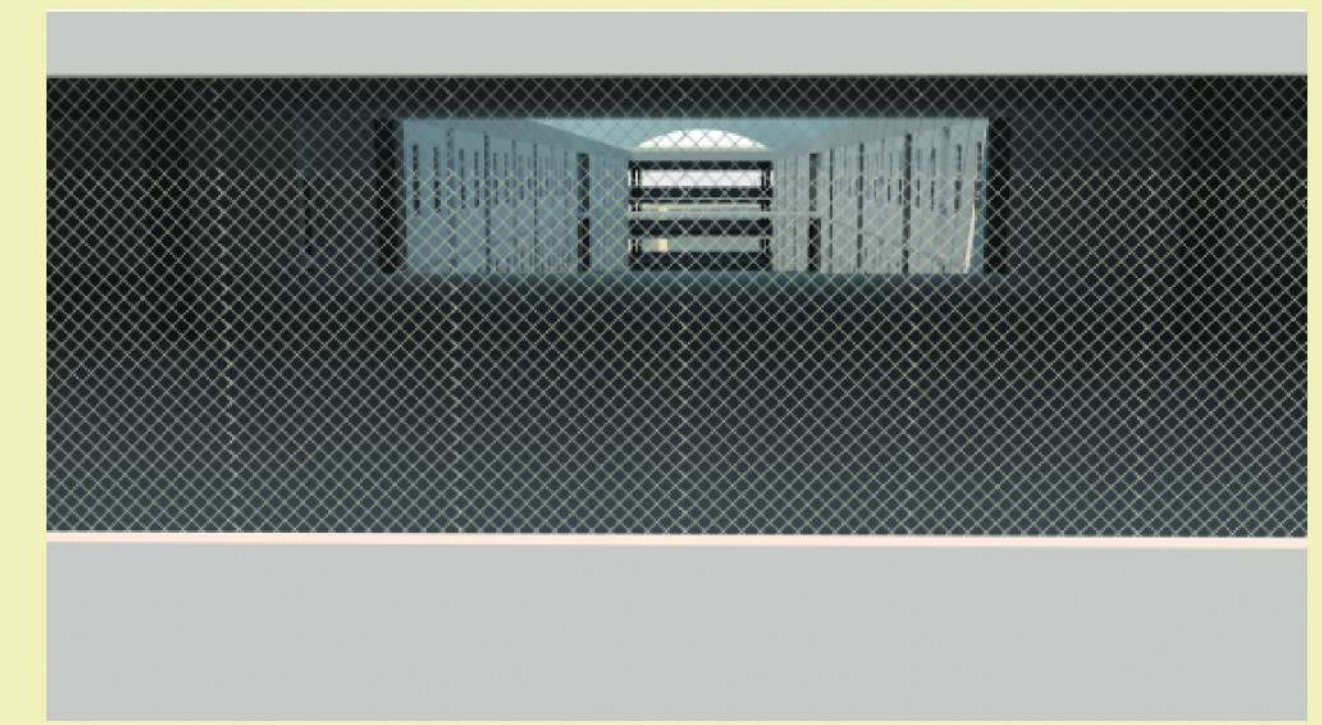

The total is 370 units. Each 2 bedrooms unit sizes 6,2m x 8,5m each bedroom sizes 2,5m x 4m

CONCEPT

Shape looks like a "Lock" so that refugees will feel safe. The facilities are needed for the mental health of the refugees. Market and Soccer field will create a good social interaction with the host communities.

